



19<sup>TH</sup> August 2020

Dear Parent/Carer

**LYMM HIGH SCHOOL GUIDANCE: GCSE RESULTS DAY 2020  
GCSE RESULTS DAY –THURSDAY 20 AUGUST 2020 (FROM 8.30AM)**

GCSE Results Day will run as originally planned on Thursday 20 August. We are giving students the option to either come into school to collect their results at 8:30 or 9.00am (dependant on surname) or receive them via email. **Students must email [exams@lymmhigh.org.uk](mailto:exams@lymmhigh.org.uk) by 31 July 2020 if they wish for their results to be sent via email.**

The collection of results will look different from previous years as we must consider the current social distancing guidelines set by the Government, especially when hosting such an important day.

To maintain safe social distancing, we are implementing the following safety measures:

- 1 Providing staggered times and locations to ensure that a limited number of students are on site at one time – see detailed information below. We must also insist that anyone who has coronavirus symptoms, or who has someone in their household with symptoms, does not attend school to collect their results.
- 2 Requesting that all parents/carers remain in their cars/off site, as we cannot allow them onto the school premises. We understand this is not ideal, but we feel it is necessary to reduce the number of people present on site at one time. We ask that parents/carers do not gather at entrance gates or doors or enter our school site unless they have a prearranged appointment.
- 3 Implementing a one-way system that also ensures students are given the opportunity to talk to the relevant staff in a support room, if they are worried about their results.
- 4 Providing hand sanitiser upon arrival. We also ask that students bring their own pens as they will be required to sign for their results. **They must also wear a face covering.**
- 5 Staff responsible for preparing results will wear the appropriate PPE.
- 6 Sixth form enrolment will be electronic this year. Students will receive details in their results envelope and via email to explain how this will work.

\*Please note, all Year 10 English Literature results and any Year 12/13 students receiving GCSE resit results will have these emailed directly to their school email account at 11.00am. Year 10 students are advised to see the separate letter from Mrs Feast **here**.

See below for details of where students will receive their results. Please also look carefully at the maps attached, as these will show you which entrance and exits students must use on the day. Results will ONLY be available during the time slots below.

Headteacher: Mr Gwyn Williams

Lymm High School, Oughtrington Lane, Lymm, WA13 0RB  
01925 755458 [info@lymmhigh.org.uk](mailto:info@lymmhigh.org.uk) [www.lymmhigh.org.uk](http://www.lymmhigh.org.uk)



Surname	Location	Time	Support and guidance room
A-C	Main Hall	8:30am	E206
D-G	Main Hall	9am	
H-I	Gym	8:30am	E106
J-M	Gym	9am	
N-S	Sports Hall	8:30am	Library
T-Z	Sports Hall	9am	

\*The careers advisor will be based in the library. If a student needs to see her, they should go to the support room allocated and this will be arranged. Please be aware that you may be asked to come back to school at a later time, or you may be offered a telephone/Zoom meeting.

We will be providing further information on Results Day, which will inform students of their next steps or what to do in the event that their results are perhaps not what they were expecting. We cannot imagine that this will impact vast numbers of students, but further information will be provided to support any decisions which need to take place in light of results achieved.

If you have any queries, please contact Mrs Feast [efeast@lymmhigh.org.uk](mailto:efeast@lymmhigh.org.uk).

We look forward to celebrating with the students.

Yours faithfully



**H JENNINGS (Mrs)**  
Assistant Headteacher, Head of Sixth form



**E FEAST (Mrs)**  
Assistant Headteacher, Head of Year 11

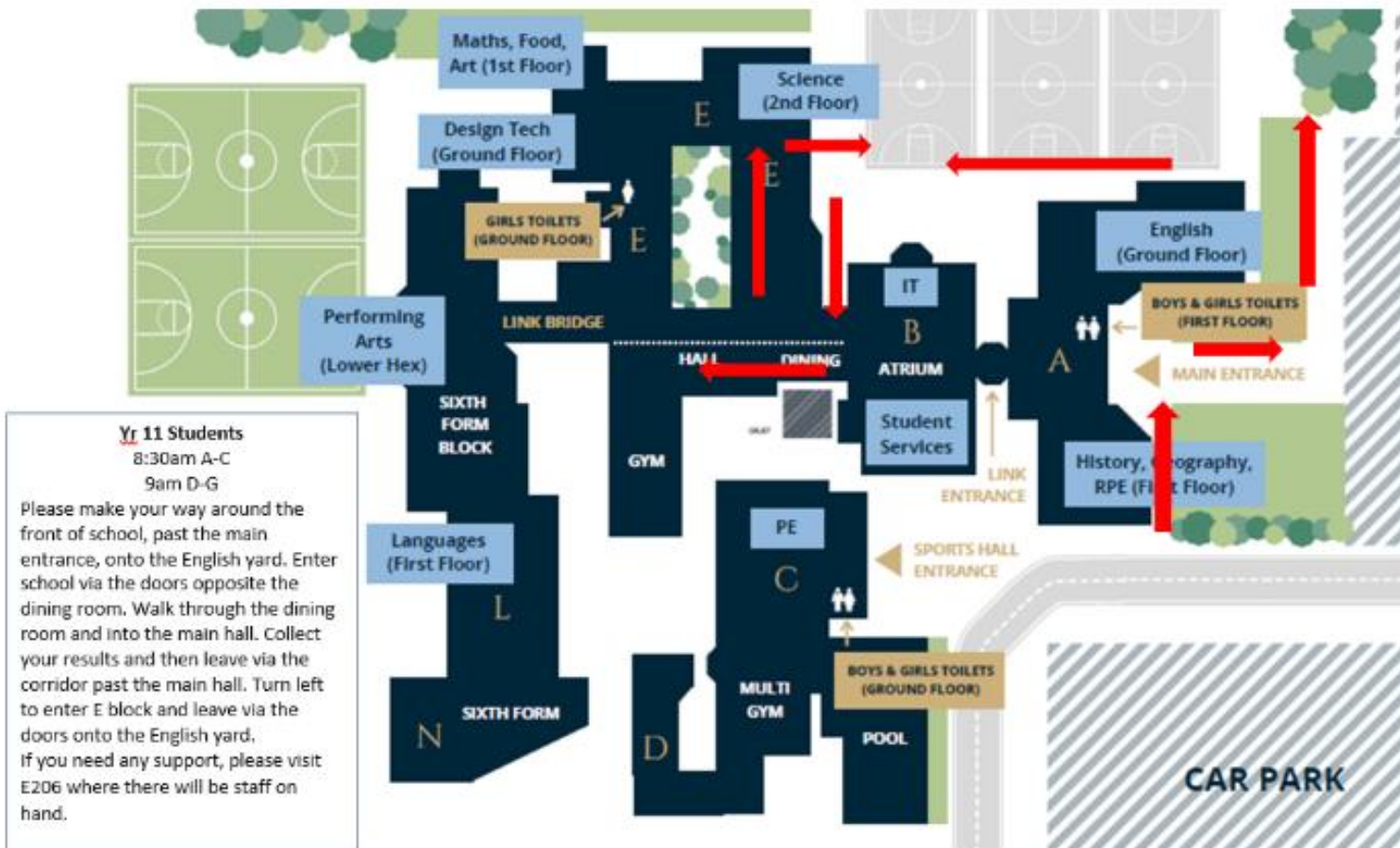



### Yr 11 Students

8:30am H-I  
9am J-M

Please enter the school site from the sixth form entrance. Your parents/carers are welcome to park in the 6<sup>th</sup> form car park. To collect your results, walk through the languages yard, enter the gym via the external door up the stairs. Collect your results from the gym and leave through the PE corridor and out onto languages yard via the PE double doors. You must exit the school site via the sixth form entrance.

If you need any support, please visit the lower hexagon where there will be staff on hand.





**Yr.11 Students**

**8:30am N-S**  
**9am T-Z**

You will enter the Sports Hall by walking along the right-hand side of the leisure centre, through the McCorms yard, entering the Sports Hall up the metal stairs. Once you collect your results from the sports hall you must leave through the other exit at the far side of the sports hall. You must walk on the lower path next to the gym, walk up the outside steps and back out through the McCorms yard. If you need any support, please visit the library where there will be staff on hand. Parents are welcome to park in the leisure centre car park