

Go Traffic Management

This drawing has been produced for a specific client & project identified below and is not intended for use by any other person or for any other purpose. © Go Traffic Management

Risks

- Design completed from information provided + google maps desktop risk assessment
- Cone lamps must be used on all road with A speed limit of 40mph or more.

Notes

- All signs as per Chapter 8. Distances between cones to be 9m maximum unless otherwise noted.
- Distances between signs NOT to scale for purpose of clarity.
- All sign placement subject to available safe working space.
- The purpose of the Traffic Management Plan is for it to be used only as a guide and all traffic management equipment should be put out according to the 'Safety at Street Works and Road Works - Code of Practice', i.e. Red Book & the 'Traffic Signs Manual Chapter 8', i.e. Yellow Book.
- Lane width past the works to be 3.5m maximum, 3.25m desirable minimum and 3.0m absolute minimum.
- Stop & Go boards must be available and utilised in the event of permanent signal failure in accordance with Code of Practice.
- Signs must be placed in accordance with TSM and the scheme RAMS pack.
- Site conditions may have changed since the design of the drawing any changes which subsequently affect the design need to be reported by the Traffic Management Operative & any changes implemented must comply with Chapter 8.

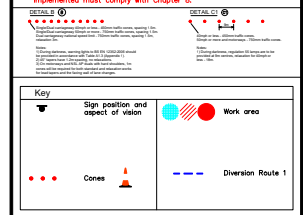

MINIMUM SAFETY ZONE MUST BE ADHERED TO

MINIMUM SHUTTLE LANE WIDTHS MUST BE ADHERED TO

Traffic Management must comply with The Safety at Street Works and Road Works Code of Practice

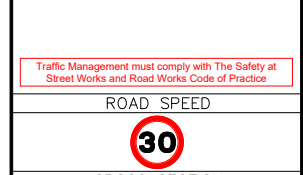

DO NOT SCALE FROM THIS DRAWING

REV.	DATE	AS DRAWN	DESCRIPTION
B	19/10/21		CHANGED DIVERSION ROUTE
A	10/09/21	AS DRAWN	

GTM
Go Traffic Management

Head Office: Go Traffic Management, Chaddock Lane, Worsley, Manchester, M28 1XW
Tel: 0161 351 5370
www.gtm.co.uk

TRAFFIC MANAGEMENT PLAN

Client: **Cadent**
Your Gas Network

Drawing Number: 239508.0002

Drawing Title: Massey Brook Lane, Lymm, WA13 0EQ

